

FS/1R + FS/2R ACCESSORIES

WT 5 CIRCULATION LANCE

5

SOLAR TANK



Circulation lance

A circulation lance for preheating hot water is used in tanks with up to 5 kW circulation loss. A lance is mounted directly to the hot water connection of the tank.

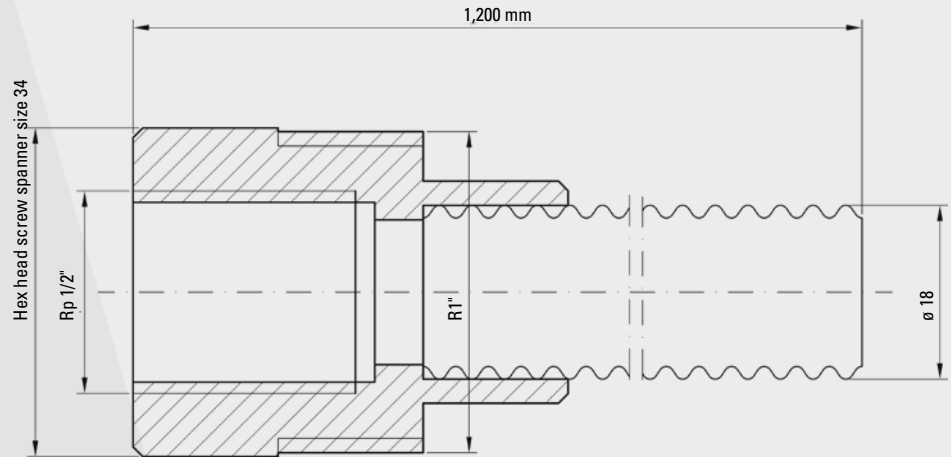

Specifications

Type	WT 5
Item no.	1620012
Head piece	Material: AISI 303; hex head screw spanner size 34; female thread: Rp 1/2"; thread depth: 23 mm; male thread: R 1"; thread length: 15 mm.
Corrugated stainless-steel pipe	Material: AISI 316L, DN 18

Can be used for circulation losses up to 5 kW (see performance data).

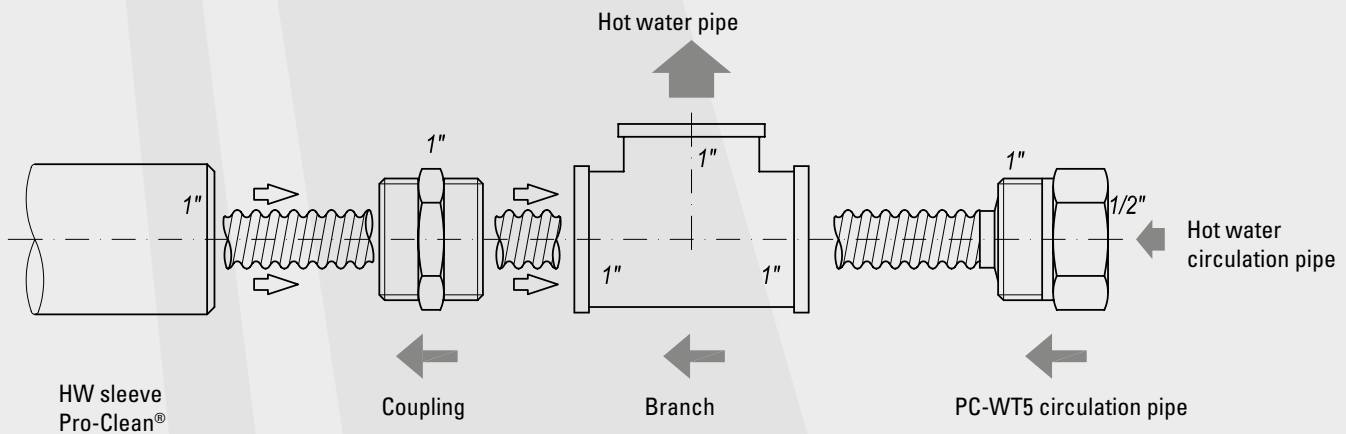

The threaded connections have to be sealed properly (hemp, sealing compound, ...).

FS/1R + FS/2R ACCESSORIES

WT 5 CIRCULATION LANCE – CONTD.

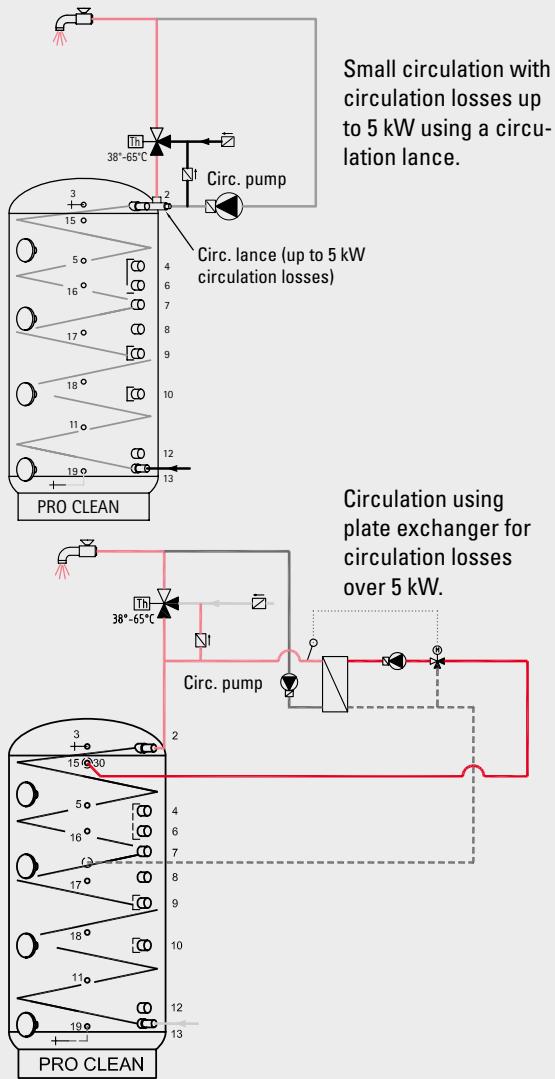

Hot water circulation performance of Pro-Clean® 1,000 I

Circ. forward flow [°C]	Circ. return flow [°C]	Flow in circulation system [l/h]	Performance [W]	Pressure loss p [mbar]
50 °C¹⁾				
38.6	32.1	500	3770	350
39.2	33.1	400	2828	300
40.0	32.7	300	2538	240
40.4	31.9	200	1972	200
40.5	30.5	100	1160	110
55 °C¹⁾				
41.4	33.1	500	4814	350
41.6	33.4	400	3799	300
42.5	32.5	300	3480	240
42.8	32.0	200	2501	200
42.9	31.8	100	1283	110
60 °C¹⁾				
42.7	32.5	500	5873	350
43.2	33.4	400	4858	300
45.7	34.0	300	3741	240
46.5	33.8	200	2944	200
46.8	33.0	100	1595	110

¹⁾ Upper tank temperature.

Pressure loss for circulation lance

